

The following features are available in this PDF document.



### **Quick Keyword Search**

Enter the keyword in the search box and hit the search button



### **Quick Jump between Chapters**

Click the title of a specific chapter on the Contents to jump to it

\*Reading software such as Adobe Reader is needed to support the functions above.



# WEEBILL 3S

User Guide

# Contents

□ Product List	
Product List	1
□ Get to Know WEEBILL 3S	
Get to Know WEEBILL 3S	3
□ Battery and Charging	
Battery and Charging	4
□ Mounting and Balancing	
Mounting the Tripod	5
Mounting the Camera	5
Installing TransMount Wrist Rest 2S and TransMount Extendable Sling Grip 2S (hereinafter referred to as “Sling Grip” and “Wrist Rest” )	10
Balancing	13
□ How to Use WEEBILL 3S	
Button Description	15
Display Screen Description	16
Icon Description	17
Menu Description	19
Motor Torque Adjustment	23
Bluetooth Shutter Control	24
Gimbal Mode Description	25
Manual Reposition	28
Use with TransMount Video Transmission Transmitter (AI) (hereinafter referred to as “transmitter AI”)	29

□ How to Use the App	
Downloading the App · · · · ·	33
How to Connect · · · · ·	33
ZY Play Feature Description · · · · ·	35
□ Firmware Upgrade & Calibration	
Circumstances When Calibration Is Needed · · · · ·	36
Six-side Calibration · · · · ·	36
Motor Fine-Tuning · · · · ·	38
Firmware Upgrade · · · · ·	38
□ Product Specifications	
□ Disclaimer and Warning	
Reading Tips · · · · ·	43
WARNING · · · · ·	43
Safe Operation Guidelines · · · · ·	44
□ Warranty Card	
Warranty Period · · · · ·	45
Warranty Exclusions · · · · ·	45
Warranty Claim Procedure · · · · ·	45
□ Contact Card	



## Product List

Before using this product, please check carefully that all the following items are included in the product package. In case that any item is found missing, please contact ZHIYUN or your local selling agent.

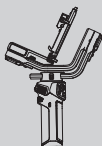

WEEBILL 3S x1

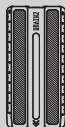

Quick Release Plate x1



Tripod x1

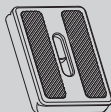

Camera Backing Base x1



Lens Support x1  
Lens Support Lock Screw x1

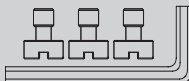

1/4" Screw x3  
M4 Wrench x1

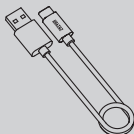

USB Type-C Cable x1

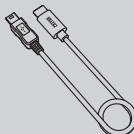

Type-C to Mini USB LN-NBUC-A01  
Camera Control Cable x1

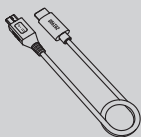

Type-C to Micro USB LN-MBUC-A02  
Camera Control Cablex1

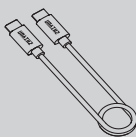

Type-C to Type-C USB LN-UCUC-A02  
Camera Control Cablex1

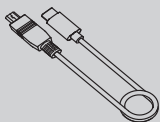

Type-C to Multi USB LN-UCUS-A03  
Camera Control Cablex1



Quick Start Guide x1



TransMount Wrist Rest 2S x1\*

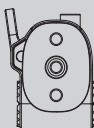

Sling Grip/Wrist Rest Basex1\*



TransMount Extendable Sling Grip 2S  
x1\*



Storage Case x1



Backpack x1\*

## Get to Know WEEBILL 3S

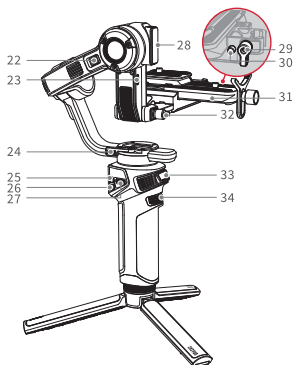
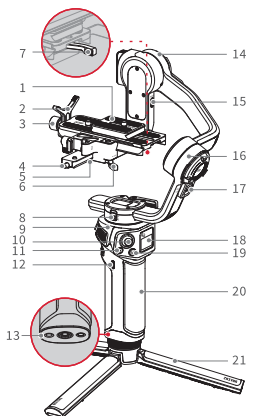

1. Camera Backing Base
2. Lens Support
3. Lens Support Lock Screw
4. Level Mount Lock Screw
5. Level Mount
6. Quick Release Plate Latch
7. Quick Release Plate Leveling Base Latch
8. Pan Axis Lock Switch
9. Pan Axis Motor
10. Joystick
11. Photo/Video Button
12. Firmware Upgrade/Charging Port
13. 1/4" Threaded Hole
14. Tilt Axis Motor
15. Camera/Image Transmission Control Port
16. Roll Axis Motor

17. Roll Axis Lock Switch
18. Display Screen
19. Mode Switch
20. Gimbal Handle
21. Tripod
22. Tilt Axis Lock Switch
23. Focus Motor Control Port
24. Pan Axis Latch
25. Power Button
26. Menu/Return Button
27. Fill Light Control Wheel
28. Fill Light
29. Leveling Base Lock Screw
30. Quick Release Plate Safety Lock
31. Quick Release Plate
32. Level Mount Lock Screw
33. Trigger Button
34. Adjustment Wheel

### Battery and Charging

WEEBILL 3S adopts built-in battery. When using WEEBILL 3S for the first time, please activate the gimbal by fully charging the battery to ensure the proper function of the gimbal.

Charging method: Use provided USB Type-C cable to connect the USB charger (not included in the package) to charge WEEBILL 3S. It is recommended to use USB chargers that meet the PD protocol. (supports 14W PD charging at most).

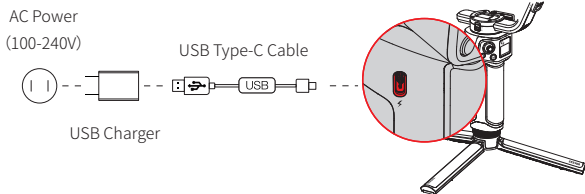

- ① USB charger is not provided.
- ② Please power off WEEBILL 3S to charge.

## Mounting the Tripod

Mount the tripod to the bottom of the WEEBILL 3S handle, then unfold the tripod and place the WEEBILL 3S on a flat surface.

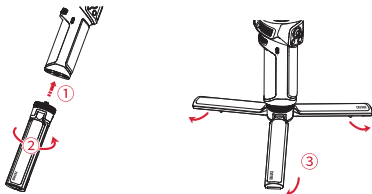

## Mounting the Camera

1. Each axis of the gimbal is equipped with a lock switch. You can use these lock switches to lock the axes for convenient installation and storage. The storage state is the default state. Please toggle the lock switch to unlock the three axes, expand the gimbal as shown in the image, and lock the axes again for convenient camera installation.

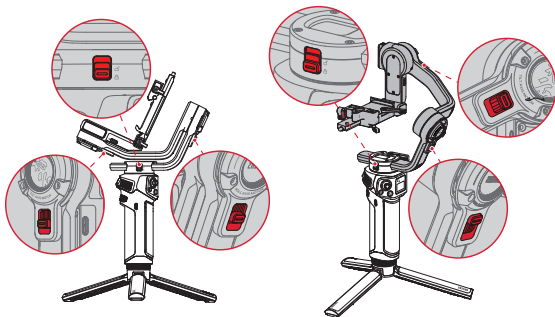

Locked state for storage

Locked state for installation

- ① Please mount the camera before powering on WEEBILL 3S and balance the gimbal. Do not power on WEEBILL 3S when there's no camera mounted on it.
- ② Before mounting the camera, make sure it is prepared ahead of time. Remove the lens cap and make sure the camera's battery and memory card are already in place.

2. Mount the camera on the camera backing base and tighten screw ① . Install the camera backing base and camera on the quick release plate ② and tighten the screw ③ . Install the lens support to the quick release plate, adjust the lens support on the quick release plate to support the lens and ensure it is stable ④ . Tighten the screw ⑤ .

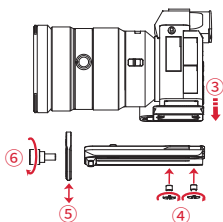
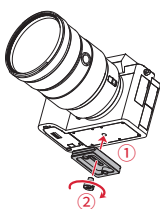

💡 ① Generally, it is only necessary to install a camera backing base when the size and weight of the lens are larger than that of the camera itself. You can determine whether to install a camera backing base according to actual usage.

② When the camera lens is long and heavy, it is necessary to install a camera lens support to ensure stable installation of the lens. You can decide whether to install a camera lens support according to your actual needs.

## 3. Installation for Landscape Orientation

Unlock the quick release plate latch ① , install the quick release plate and camera onto the quick release plate leveling base ② and then tighten the latch ③ .

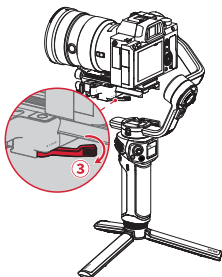
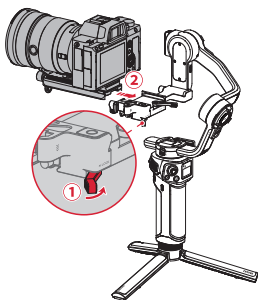

### 4. Installation for Portrait Orientation

Unlock the quick release plate leveling base latch ① . Press and hold the leveling base safety lock ② and push the leveling base to the left until it is removed from the level mount ③ . Install the camera and quick release plate as a whole onto the leveling base ④ and tighten the latch ⑤ . Install the camera, quick release plate, and leveling base as a whole onto the level mount ⑥ . Tighten the leveling base lock screw ⑦ .

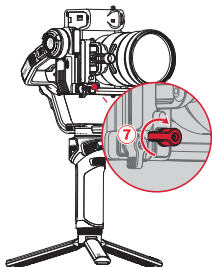
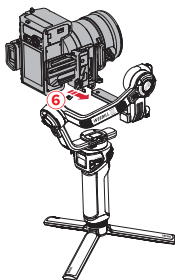
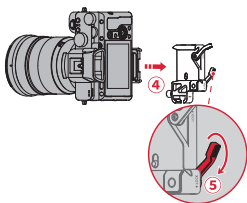
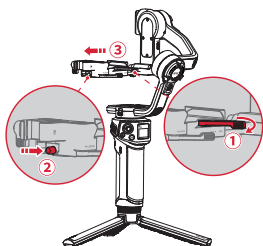

- 💡 When disassembling at horizontal orientation, please unlock the quick release plate latch ① and hold down the safety lock of the quick release plate ② to remove the camera and quick release plate as a whole ③ .

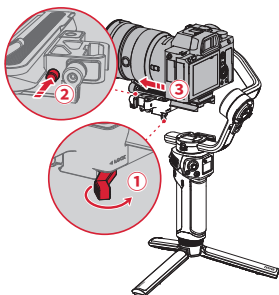

- 💡 When disassembling at portrait orientation, please loosen the screw that locks the leveling base ① , and hold down the safety lock of the leveling base ② to remove the camera, quick release plate and leveling base as a whole from level mount ③ .

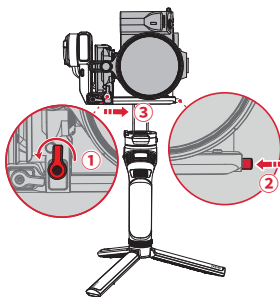



Connect the camera control cable to the camera control port and the camera/image transmission control port of the gimbal.

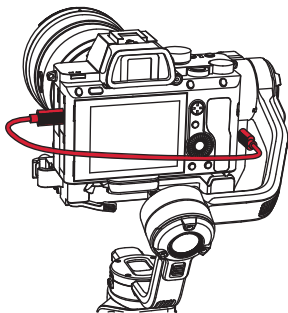

💡 There are four camera control cables: Type-C to Multi USB / Type-C to Type-C USB / Type-C to Micro USB / Type-C to Mini USB. Choose the correct cable corresponding to the USB port type of the camera. For compatibility details, please visit the official website of ZHIYUN ([www.zhiyun-tech.com](http://www.zhiyun-tech.com)) and check the WEEBILL 3S Camera Compatibility List.

## Installing TransMount Wrist Rest 2S and TransMount Extendable Sling Grip 2S (hereinafter referred to as “Sling Grip” and “Wrist Rest” )

### Installing Sling Grip/Wrist Rest Base

Align the installation screws of the sling grip/wrist rest base with the 1/4" screw hole on the bottom of the WEEBILL 3S handle ① and tighten the two screws ② . align the guide rails of the base with the base connector in the direction shown in the figure and install it onto the connector ③ , and then tighten the latch of the base ④ .

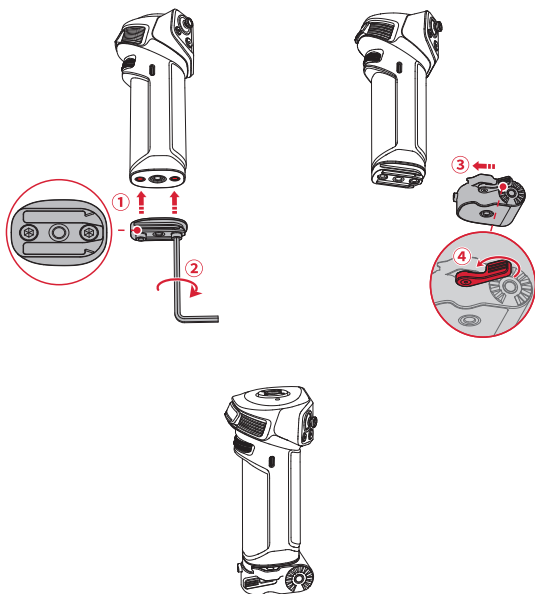

### Installing Sling Grip

Align the installation screw of the sling grip with the installation screw hole

① , adjust the sling grip to the appropriate position and tighten the screw ② .

Rotate the sling grip to the far right ③ , and tighten the sling grip lock screw after adjustment is completed ④ . The sling grip can also be rotated to the far left and adjusted for dual-hand use.

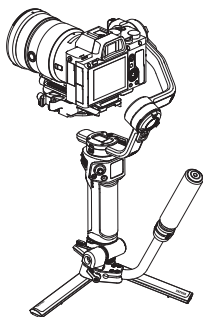
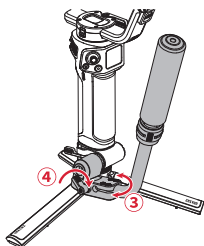
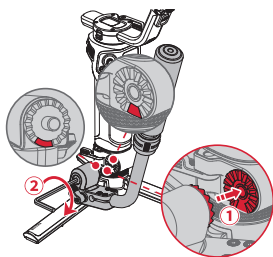

Sling Mode

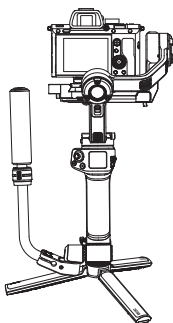

Dual-Hand Mode

## Installing Wrist Rest

Align the installation screw of the wrist rest with the installation screw hole ① , adjust the wrist rest to the appropriate position and tighten the screw ② , and the installation is completed. According to usage needs, adjust the position of the screw by rotating the wrist rest angle ③ .

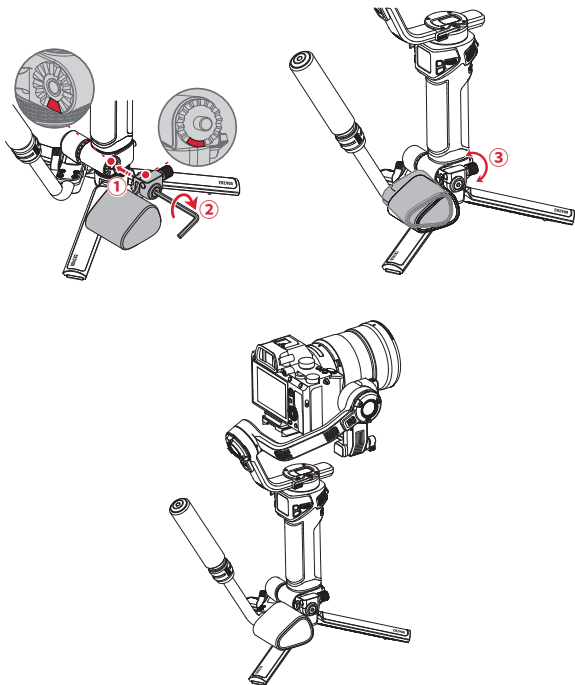

Installation completed

💡 Please adjust the sling grip and wrist rest to a proper position to avoid unpleasant user experience. The sling grip is extendable, you can adjust it to the length that best suits you.

## Balancing

### 1. Horizontal Balance of the Tilt Axis

Unlock the tilt axis lock switch ① and loosen the quick release plate latch ② . Push the camera to move forward or backward ③ until the camera can stay still and almost level with its lens facing front ④ . Complete this step by tightening up the quick release plate latch ⑤ .

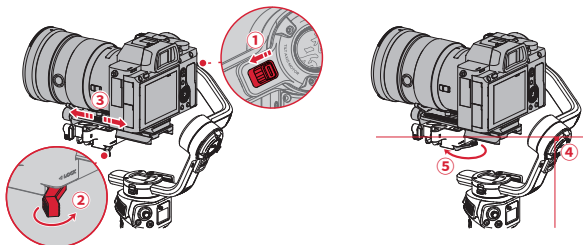

### 2. Vertical Balance of the Tilt Axis

Make the lens face up, loosen the level mount lock screw ① . Push the whole level mount to move forward or backward ② . Push until the camera can stay still with the lens facing up (i.e.the camera stays still and vertical to the ground) ③ . Complete this step by tightening up the screw ④ .

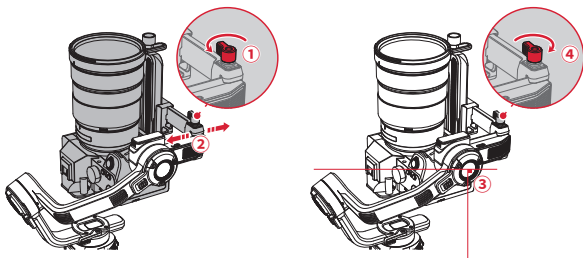

## 3. Roll Axis Balance

Unlock the roll axis ① and loosen the quick release plate leveling base latch ② . Push the camera to move left or right ③ until the camera can stay still and horizontal to the ground ④ . Complete this step by tightening up the latch ⑤ .

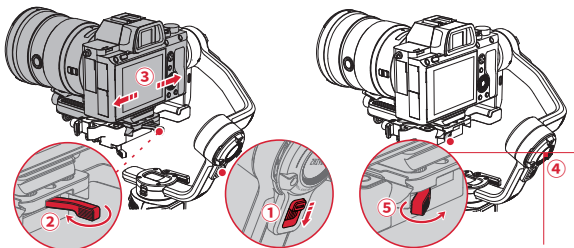

## 4. Pan Axis Balance

Unlock the pan axis ① , loosen the pan axis latch ② , hold and slightly tilt the handle, push the pan axis to move left or right ③ until the pan axis can stay still in any position. Complete this step by tightening up the pan axis latch ④ .

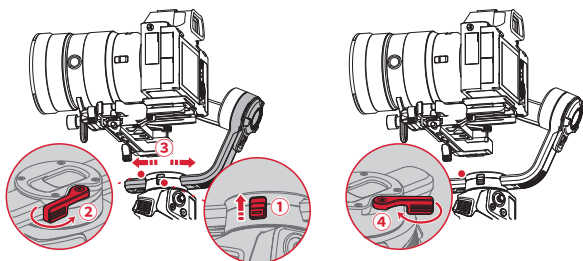

① The balancing steps for the portrait orientation are the same as the landscape orientation.

② After balancing WEEBILL 3S, the motor torque needs to be adjusted for proper function. For the adjustment details, please see the methods introduced in "Motor Torque Adjustment".

## Button Description

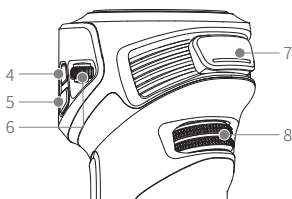
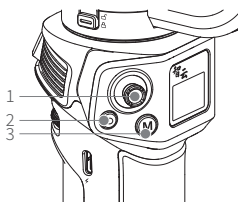

### 1. Joystick

Push up/down/left/right to control the gimbal to rotate.



### 2. Photo/Video Button

Half press: Activate auto-focus on certain cameras.

Long press: Take a photo.

Single press: Start/stop filming a video.



### 3. Mode Switch

Single press: Switch among PF/L/F mode.

Double press: Switch among POV/V/Portrait mode.

Long press: Sleep/wake mode for the gimbal motors.



### 4. Power Button

Long press: Turn on/off the gimbal.



### 5. Menu/Return Button

Single press: Enter/exit main menu. When in the submenu, press to return to the previous menu.



## 6. Fill Light Control Wheel

Single press: When the fill light is on, press to switch between fill light brightness/color temperature level. When in the menu, press to confirm.

Scroll: When the fill light is on, scroll to adjust fill light brightness/color temperature level. When in the menu, scroll to select menu/adjust parameters.

Long press: Turn on/off the fill light.



## 7. Trigger Button

Single press: Switch to customized gimbal mode (Follow mode by default)/Return to the previous mode.

Double press: Gimbal reposition.

Triple press: Selfie mode.

Long press: Enter Go mode. Release to return to the previous mode. When in the portrait orientation, long press to lock the gimbal. Motors of three axes won't move with the handle. Release to unlock the gimbal and the motors of tilt axis and roll axis will move with the handle.



## 8. Adjustment Wheel

Scroll: Adjust parameters customized in the screen menu (aperture, shutter, ISO, digital focus/zoom, roll axis, tilt axis, pan axis).

## Display Screen Description



Main page  
(set as default)



Main interface  
(when connected to camera)



Main Interface  
(when connected to camera and fill light is on)





Shooting a video

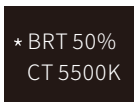

Fill light brightness/  
color temperature level  
adjustment interface

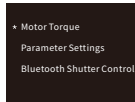

Main menu

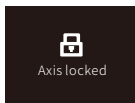



Axis locked



Standby

## Icon Description

	Camera and gimbal are successfully connected
	Video transmission transmitter AI and gimbal are successfully connected
	Current gimbal battery level
	Indicates that the locks on the three axes have not been released and an alarm will sound (press and hold the M button to release the locks, and resume operation)
	Standby icon, displayed when the motor is in sleep mode
	Camera connected to gimbal
	Camera shooting a video

	Fill light is on
	Gimbal connected to camera Bluetooth
<b>PF</b>	Gimbal in Pan Follow Mode
<b>L</b>	Gimbal in Lock Mode
<b>POV</b>	Gimbal in Point Of View Mode
<b>V</b>	Gimbal in Vortex Mode
<b>F</b>	Gimbal in Follow Mode
<b>GO</b>	Gimbal in Go Mode
<b>P</b>	Gimbal in Portrait Mode
<b>AV</b>	Current camera aperture value
<b>TV</b>	Current camera shutter speed
<b>ISO</b>	Current camera ISO value
	Current camera EV value

## Menu Description

<b>Motor Torque</b>	Auto Calibration		
	Custom	Tilt axis	
		Roll axis	
		Pan axis	
	Level	Low	
		Medium	
		High	
<b>Parameter Settings</b>	Speed	Joystick control	Tilt axis
			Roll axis
			Pan axis
		Motor follow speed	Tilt axis
			Roll axis
			Pan axis
	Smoothness	Tilt axis	
		Roll axis	
		Pan axis	
	Deadband	Tilt axis	
		Roll axis	
		Pan axis	

Parameter Settings	Responsiveness	16/24/35/50/70/105mm	For better tracking results, please choose the current focal length corresponding to the lens in the menu. (For example, if the current focal length of the lens is 50mm then choose "50mm" in the menu.)
	Restore Default Settings	Confirm	
		Cancel	
Bluetooth Shutter Control	Please check if you turn on the camera Bluetooth...		
Control Wheel Setting	Control Wheel Setting	focus	
		Zoom	
		Electronic follow focus	
		Electronic zoom	
		Aperture	
		Shutter	
		ISO	
		Tilt axis	
		Roll axis	
		Pan axis	
		Disable control wheel	

Control Wheel Setting	Reverse	Off	
		On	
	Sensitivity	Low	
		Medium	
		High	
Joystick Setting	Reverse	Vertical	Off
			On
		Horizontal	Off
			On
Trigger Button Function	PF/L/F/POV/V/P	Set the operation mode when pressing the trigger button once	
V Mode Settings*	Speed	Rotation speed	
	Orientation	Clockwise	
		Counterclockwise	
	Angle	Unlimited	
		Custom	Turns
	Start		

Motionlapse	Preset	Two preset paths available: preset1/preset 2	
	Mode	Two modes available: photo/video	
	Points	Five at most key points can be set (A, B, C, D, E)	
	Time	"interval" for the time interval of photo taking "duration" for the total amount of time	
	Preview	Quick preview of the set path	
	Start	Enable motionlapse	
Follow Focus Motor Settings	Focus/zoom	Sensitivity	Low
			Mediumn
			High
		AB**	A
			B
			Clear
		Reverse	Off
			On
Angle Fine-tuning	Tilt axis		
	Roll axis		
Restore Default Settings	Confirm		
	Cancel		
Language	Simplified Chinese		
	English		
About	Product Name, Firmware Version, Bluetooth Name		

\*To enter: Switch the gimbal mode to V mode, press the fill light control wheel in the V Mode Setting menu.

To exit: Single press the mode switch.

\*\*AB point settings are only available when connecting to ZHIYUN Servo Follow Focus correctly.

### Motor Torque Adjustment

After balancing WEEBILL 3S, the motor torque needs to be adjusted for proper function. You can adjust the motor torque according to the weight of your camera and lens, so that the WEEBILL 3S can be used in its ideal state. Following are three methods for adjustment. It is recommended to use auto-calibration.

#### 1. Auto Calibration

Auto calibration will adjust the motor torque according to the weight of the carried camera and lens.

**Operation steps:** Press Menu / Return button to enter the menu. Rotate the fill light control wheel to select “Motor torque” and press the wheel to enter the next menu. Rotate the control wheel to select “auto calibration” and press the control wheel to confirm. The gimbal will then enter auto calibration mode. Please don't touch the gimbal and wait for the display screen to show the “√” mark after the gimbal shakes. The auto calibration is then complete.

#### 2. Custom

The power determines the torque of the motor, and needs to be adjusted according to the camera and the lens on the gimbal. The power should be proportional to the weight of the load. A high power value will cause the gimbal itself to vibrate, while a value that is too low will affect the stability of the gimbal.

**Operation steps:** Press Menu/Return button to enter the menu and select “Motor Torque”. Press the fill light control wheel to enter the next menu. Rotate the control wheel to select “custom” and press the control wheel to enter the adjustment interface. Rotate the control wheel to select the axis you wish to adjust and press the 24 control wheel to confirm. To set the power value, you can rotate the control wheel. To complete the setting, press the control wheel to exit the interface, press the Menu/Return button to save the settings and return to the previous menu. When the display screen shows the “√” mark, the adjustment is complete.

### 3. Level

Three motor torque levels from low to high are provided based on the combined weight of mainstream camera lenses available on the market. Users can select the corresponding motor torque level according to the weight of their camera and lens.

**Operation steps:** Press Menu/Return button and rotate the fill light control wheel to select “Motor torque”. Press the control wheel to enter the next menu and rotate the control wheel to select “level”. Press the control wheel to enter the next menu, select your desired level and press the control wheel to confirm. When the display screen shows the “√” mark, the selection is complete.

- 💡 ① When adjusting the motor torque, make sure that the lock switches of the three axes on the gimbal are turned on, and the gimbal is upright and placed on level ground.
- ② If a load is changed, please readjust the balance and adjust the power values using the method mentioned above.
- ③ It is recommended to use auto-calibration first. If auto-calibration fails to meet your requirements, you can use custom settings to fine-tune the values. If the above two methods still do not meet your requirements, use the level adjustment to select the power.

### Bluetooth Shutter Control

WEEBILL 3S supports Bluetooth shutter control, which allows you to wirelessly control the camera shutter without connecting a camera control cable. Before connecting the camera Bluetooth to WEEBILL 3S, please turn on the camera's Bluetooth and enter pairing mode. Then press the menu/return button on WEEBILL 3S to enter the main menu, rotate the fill light control wheel and select Bluetooth shutter control, and single press the fill light control wheel to confirm. WEEBILL 3S will then automatically search for the camera Bluetooth name. Select the Bluetooth name that needs to be connected, press the control wheel to confirm the connection, and finally confirm the connection on the camera.

- 💡 ① After WEEBILL 3S and the camera complete pairing and successfully connect Bluetooth for the first time, they can automatically connect to Bluetooth next time.
- ② When WEEBILL 3S and the camera are connected through both camera control cables and Bluetooth at the same time, the gimbal prioritizes controlling the camera function through the camera control cable.



- ③ After WEEBILL 3S and the camera are connected via Bluetooth, the Bluetooth connection can be disconnected in the Bluetooth shutter control menu.
- ④ For specific camera models that support Bluetooth control in WEEBILL 3S please visit the ZHIYUN official website [www.zhiyun-tech.com](http://www.zhiyun-tech.com) to check the "WEEBILL 3S Camera Compatibility List" for the latest information.

### Gimbal Mode Description

💡 Motors circled in red are free to move in line with the movement of the gimbal handle while motors circled in grey are locked.

#### Pan Follow mode (PF):

The tilt axis and roll axis motors are locked, and the camera rotates with the handle while panning horizontally. Push the joystick up / down to control the tilt axis angle, and push it left/right to control the pan axis of the camera.

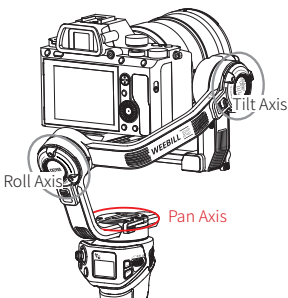

#### Lock mode (L):

All three motor angles are locked, and the camera orientation will not move with the rotation of the handle. Push the joystick up / down to change the tilt angle of the camera and left / right to change the horizontal orientation of the camera.

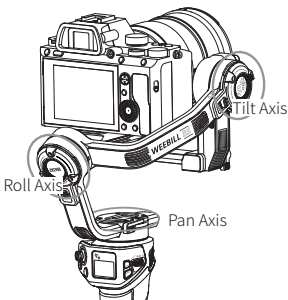

**Follow mode (F):**

The roll axis motor is locked, and the tilt axis and pan axis motors follow the rotation of the handle. Push the joystick up/down to change the tilt angle of the camera and left/right to change the horizontal orientation of the camera.

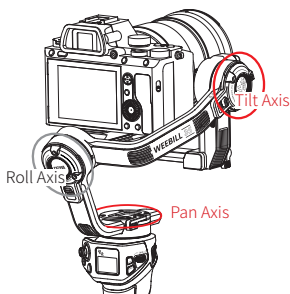
**Point of View mode (POV):**

All three motors move when the handle is rotated. Push the joystick up/down to change the tilt angle of the camera and left/right to change the horizontal orientation of the camera.

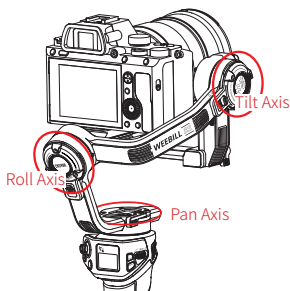

**Vortex mode (V):**

The tilt axis motor rotates upward by  $90^\circ$ , and the tilt axis, roll axis, and pan axis motors follow the rotation of the handle. Push the joystick to the left/right to control the rotation of the pan axis.

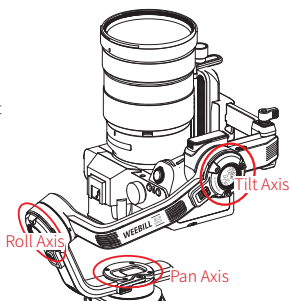
**Go mode (GO):**

The roll axis motor is locked, and the tilt axis and pan axis motors quickly follow the rotation of the handle. Push the joystick up/down to change the tilt angle of the camera and left/right to change the horizontal orientation of the camera.

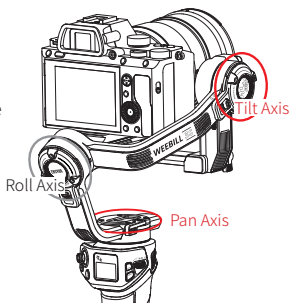

### Portrait mode (P):

The tilt axis motor rotates upward by  $90^\circ$  and the pan axis rotates counterclockwise by  $90^\circ$ . You can enter this mode for vertical shooting.

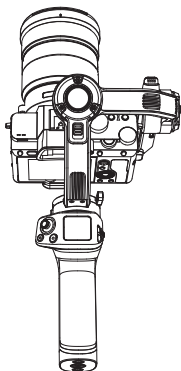

### Manual Reposition

In Pan Follow mode (PF), Lock mode (L), and Follow mode (F), the camera can be rotated by a certain angle by hand. Hold it for 2s and the camera angle will be fixed at that angle after you release the camera (tilt axis, pan axis).

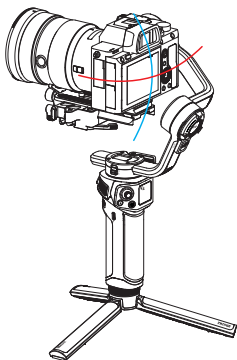

## Use with TransMount Video Transmission Transmitter (AI) (hereinafter referred to as "transmitter AI")

### Installing

1. Take out the transmitter mounting plate, mount the transmitter mounting plate to the bottom of the WEEBILL 3S's level mount (note the direction of the notch), and use the wrench to tighten the screws.

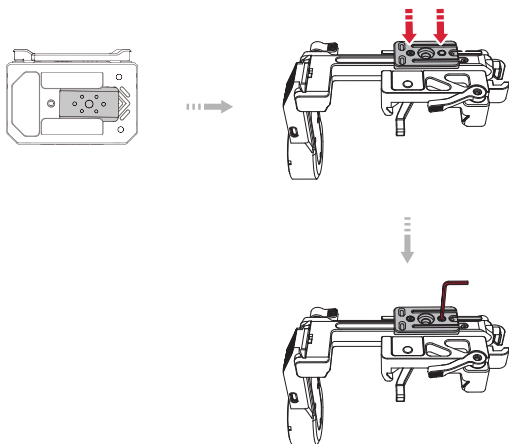

2. Place the transmitter AI with the mounting plate slot facing up, align the transmitter mounting plate, push the transmitter AI toward the tilt axis motor until it clicks into the safety lock to make sure of a firm installation.

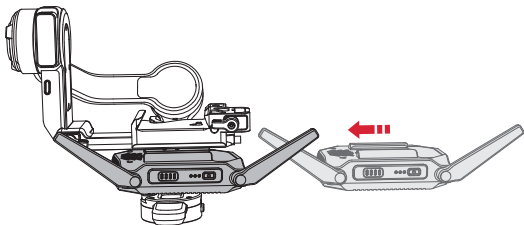

💡 In order to have the best image transmission, please rotate the antenna to the position as shown in the image. The antenna can only be rotated in one direction. Please rotate properly. For more details, please read the user guide of transmitter AI.

### Connecting

1. Take the gimbal-only cable (Type-C to Type-C LN-UCUC-A02), connect with the camera/image transmission control port of WEEBILL 3S and the Type-C charging/communication port of the transmitter AI.

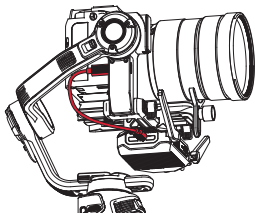



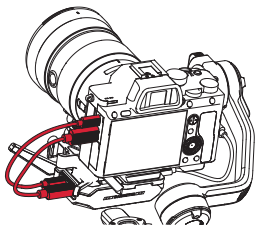

2. Take the camera control cable corresponding to the USB port model of the camera, connect to the camera control port of the transmitter AI and the USB port of the camera. Use the HDMI cable corresponding to the HDMI port model of the camera, connect to the HDMI video input port of the transmitter AI and the HDMI output port of the camera.



- ① WEEBILL 3S can also be used with TransMount Image Transmission Transmitter 2.0. The installation steps are similar to transmitter AI. Please choose proper cables when installing.
- ② It is recommended that the WEEBILL 3S and transmitter AI be shut down and powered off before plugging in or out the cable. The actual color of the cable is black. The red color used in the manual is only used for illustrative purposes.
- ③ To know how you can connect the camera control cable and the HDMI cable, please visit the official website of ZHIYUN ([www.zhiyun-tech.com](http://www.zhiyun-tech.com)) to find "TransMount Video Transmission Transmitter AI Camera Compatibility List".
- ④ After installing the device, you need to adjust the balance of the WEEBILL 3S.

### Using

1. Power on WEEBILL 3S, transmitter AI and camera. When the screen on WEEBILL 3S shows the icon[  ] and gives a “beep” sound, the connection is successful. You can then control the camera via the gimbal buttons.
2. Launch the “ZY Play” app. Select the WEEBILL 3S page and tap to connect. Select the Bluetooth name of your WEEBILL 3S to connect. (the WEEBILL 3S Bluetooth name can be found on the tilt axis USER ID: XXXX).
3. When the app enters the image transmission interface, tap the Wi-Fi icon [  ], and follow the instruction to connect the transmitter AI Wi-Fi (default password: 12345678). Tap the image transmission icon[  ], to enable image transmission. You can then watch the real-time footage of the camera on “ZY Play” app. You can also use the virtual joystick on the app to control the camera to take photos/shoot videos or control the gimbal to rotate.

 The transmitter AI should be used with the “ZY Play” app. To know how you can download the app, please see the method introduced in “How to Use the App”.



### Downloading the App



Scan the QR code on the left (Android 5.0 and above, iOS 9.0 and above required) or search "ZY Play" in App Store or Google Play to download.



- ① "ZY Play" is an app dedicatedly designed for WEEBILL 3S. When activated WEEBILL 3S via "ZY Play", you can also use it for firmware upgrades, virtual joystick control, six-side calibration, etc.
- ② ZY Play is subject to updates without notice. Please always refer to the latest version.

### How to Connect

1. Power on WEEBILL 3S and turn on Bluetooth on the smartphone.
2. Launch the "ZY Play" app. Select the WEEBILL 3S page and tap to connect. Select the Bluetooth name of your WEEBILL 3S to connect (the WEEBILL 3S Bluetooth name can be found on the side of the tilt axis USER ID: XXXX).
3. If the WEEBILL 3S is being used for the first time, you need to activate the gimbal via "ZY Play" to use the advanced features in the app. Internet connection is required.
4. After the activation succeeds, you can enter the feature interface of ZY Play App.

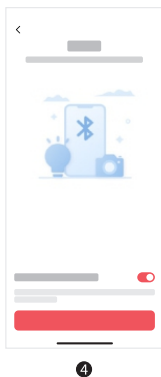
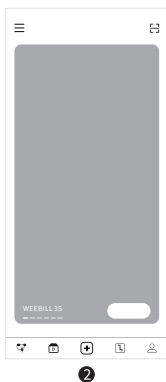
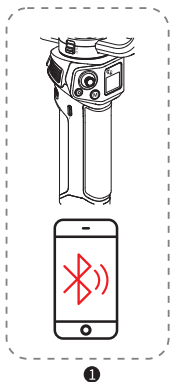

### ZY Play Feature Description



💡 For more details of the “ZY Play” app features, please visit the official website of ZHIYUN ([www.zhiyun-tech.com](http://www.zhiyun-tech.com)) and watch WEEBILL 3S video tutorials.

## Circumstances When Calibration Is Needed

Calibrate the gimbal as needed.

Calibration Reason	Calibration Method
1. Slight deviation is found in the level position after the initialization of the gimbal. 2. The gimbal has not been used for a long time. 3. The gimbal undergoes significant temperature differences in operation environments.	Six-side Calibration
Slight deviation is found in the tilt or roll angle in level position after six-side calibration of the gimbal.	Motor fine-tuning

## Six-side Calibration

### 1. Six-side calibration via APP:

According to the method introduced in "How to Use the App", please connect the gimbal to the APP, and enter "Settings"- "Six-side Calibration", then conduct the six-side calibration according to the prompt.

### 2. Six-side calibration via "Zhiyun Gimbal Tools":

Power on the gimbal and enter standby mode. Connect the charging/upgrade port of the gimbal to the computer with the Type-C USB cable, Open "Zhiyun Gimbal Tools", click "open" on the top and click "calibration" on the bottom. Please conduct the process according to the following steps. A "√" mark will appear after the calibration is completed.

- 💡 ① Please refer to the six-side calibration steps below. After the calibration is completed, please restart the gimbal.
- ② In simple terms, six-side calibration is to place all six sides of the quick release plate vertically to a level surface respectively.

Step 1

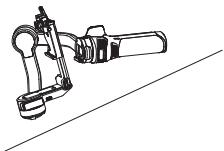

Step 2

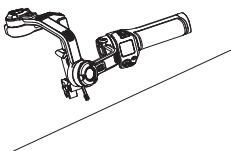

Step 3

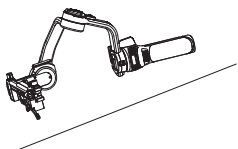

Step 4

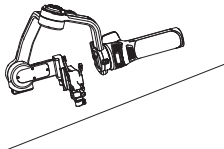

Step 5

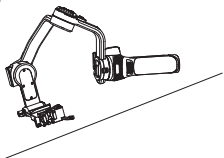

Step 6

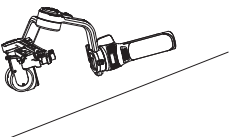

## Motor Fine-Tuning

Select “Motor Fine-tuning” in the main menu to fine-tune the value of the tilt axis and roll axis according to actual needs.

## Firmware Upgrade

You can use “Zhiyun Gimbal Tools” or “ZY Play” app to perform WEEBILL 3S firmware upgrade.

### Method One:

1. Visit the official website of ZHIYUN ([www.zhiyun-tech.com](http://www.zhiyun-tech.com)), go to the WEEBILL 3S product page, click “Download”, find the USB driver, the calibration upgrade tool and the firmware and download. (USB drivers are not required for Mac OS systems)
2. Install the driver, unzip the firmware for the documents with the “.ptz” file extension.
3. Connect the Type-C charging/upgrade port of WEEBILL 3S to the computer with the Type-C USB cable, power on WEEBILL 3S.
4. Open “Zhiyun Gimbal Tools”, click “Open”, click “Firmware Upgrade”. Click “Browse” under “Path” to select the latest firmware downloaded (with the “.ptz” file extension), and click “Upgrade” at the bottom to upgrade firmware.

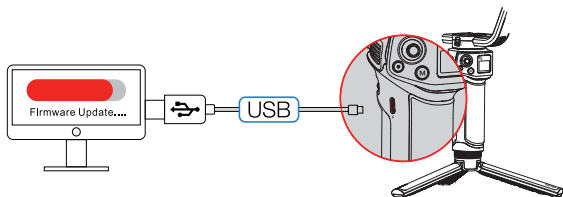

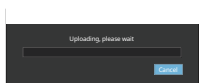
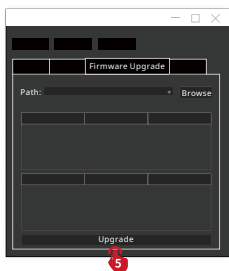
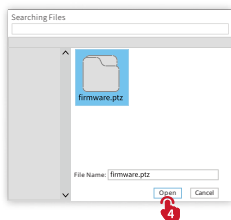
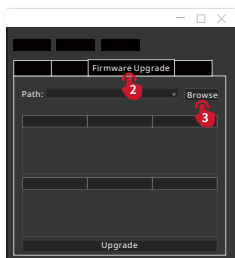
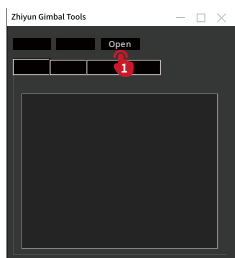

## Method Two:

When WEEBILL 3S is connected to “ZY Play” app, if a firmware update prompt pops up on the app, please follow the instructions to upgrade. Internet connection is required. To know how you can connect WEEBILL 3S to “ZY Play”, please check the method introduced in "How to Use the App".

- ① When upgrading with Method 1, please wait until the screen displays that the upgrade is finished, then you can plug out the USB Type-C cable.
- ② Before upgrading the firmware, please ensure that the WEEBILL 3S has more than 50% power remaining. You will not be able to exit the app interface or access in the background during the upgrading process. Pay attention to the prompts on the app.

Product Model: CR128

Item	Min.	Standard	Max.	Remark
Operation Voltage	6.5V	7.4V	8.4V	
Operation Current	150mA	-	5300mA	
Output Voltage (Camera Control Port)	-	5V	-	
Output Current (Camera Control Port)	-	1A	-	
Output Voltage (Focus Motor Control Port)	9.9V	-	12.6V	
Output Current (Focus Motor Control Port)	0.1A	-	2A	
Tilt Mechanical Range	-130°	-	+180°	
Roll Mechanical Range	-280°	-	60°	
Pan Mechanical Range	-	360°	-	Unlimited Rotation
Controllable Tilt Angle	-90°	-	+160°	
Controllable Roll Angle	-30°	-	+35°	
Controllable Pan Angle	-	360°	-	
Operation Temperature	-10°C	25°C	45°C	
Battery Capacity	-	2600mAh	-	
Battery Runtime		11H 30min		Lab Data 1
Charging Time		2H		Lab Data 2



Item	Min.	Standard	Max.	Remark
Gimbal Net Weight		1054.8g		
Quick Release Plate Weight		108.9g		
Tripod Weight		157.1g		
Sling Grip Weight		251.7g		
Wrist Rest Weight		139.4g		
Sling Grip/Wrist Rest Base Weight		95g		
Gimbal Size (Folded)		305*210*72.5mm		
Gimbal Size (Expanded)		306.4*181.4*161.63mm		Without tripod
Bluetooth		Bluetooth 5.0		
EIRP		< 10dBm		
Operation Frequency		2.4GHz		
Camera Charging		Able to charge 5V / 1A cameras		
1/4" Rosette Mount Screw Thread Carry Weight		≤ 3000g		

Lab Data 1: The above data is collected at a specified temperature of 25°C.

The WEEBILL 3S is fully charged with 18650-2600mAh batteries and mounted with Nikon D850+Sigma 24-70mm f/2.8L DG. The WEEBILL 3S is properly balanced and put on a flat surface. The maximum runtime is 11 hours and 30 minutes. When the battery powers the gimbal, it also charges the camera simultaneously. The battery life will be shortened in this case, so you should determine whether to turn on the camera USB power supply function. The actual duration of use will vary depending on the length of time the WEEBILL 3S is used, the number of times the battery is charged and discharged, as well as the battery's vitality. The longer the WEEBILL 3S is used, the more times the battery is charged and discharged, and the lower the battery vitality, the shorter the duration of use..

Lab Data 2: The data is collected when charging with a 9V PD Fast Charging at a specified temperature of 25°C. The charging time is 2h. The actual charging time varies with environmental factors. In addition, the lower the temperature, the longer the charging time.

All the data is collected from internal experiments of ZHIYUN laboratories. Under different scenarios, the above data is subject to a margin of error. Please refer to actual use of this product.

Thank you for purchasing this product. The information contains herein affects your safety, legitimate rights and obligation. Please read this instruction carefully to ensure proper configuration before use. Failure to read and follow this instruction and warnings herein may result in serious injury to you or bystanders, or damage to your device or property. Guilin Zhishen Information Technology Co., Ltd (hereinafter referred to as "ZHIYUN") reserves all rights for final explanation on this instruction and other documents related to the product. The information is subject to update without notice. Please visit [www.zhiyun-tech.com](http://www.zhiyun-tech.com) to obtain the latest product information.

By using this product, you hereby signify that you have read this document carefully and that you understand and agree to abide by the terms and conditions herein. You agree that you are solely responsible for your own conduct while using this product, and for any consequences thereof. You agree to use this product only for purposes that are proper and in accordance with all terms, precautions, practices, policies and guidelines ZHIYUN has made and may make available.

ZHIYUN accepts no liability for damage, injury or any legal responsibility incurred directly or indirectly from the use of this product. Users shall observe safe and lawful practices including, but not limited to, those set forth herein.

ZHIYUN™, TransMount™ are the trademark of Guilin Zhishen Information Technology Co., Ltd and its affiliates. All product names or trademarks referred to herein are trademarks or registered trademarks of their respective holders.

### Reading Tips

Legends:  Hints and Tips

 Important

### WARNING

Read the ENTIRE User Guide to become familiar with the features of this product before operating. Failure to operate the product correctly can result in damage to the product or personal property and cause serious injury. This is a sophisticated product. It must be operated with caution and common sense and requires some basic mechanical ability. Failure to operate this product in a safe and responsible manner could result in injury or damage to the product or other property. This product is not intended for use by children without direct adult supervision. DO NOT use with incompatible components or in any way otherwise as mentioned or instructed in the product documents provided by ZHIYUN. The safety guidelines herein contain instructions for safety, operation and maintenance. It is essential to read and follow all of the instructions and warnings in the User Guide, prior to assembly, setup or use, in order to operate the product correctly and avoid damage or serious injury.

### **Safe Operation Guidelines**

1. This product is a high-precision control device. Damage may be caused to this product if dropped or subject to external force, and this may result in malfunction.
2. Make sure the rotation of the gimbal axes is not blocked by external force when this product is turned on.
3. this product is not waterproof. Prevent contacts of any kind of liquid or cleaner with the this product. It is recommended to use dry cloth for cleaning.
4. Protect this product from dust and sand during use.

### **Warranty Period**

1. Customers are entitled to replacement or free repair service in case of quality deficits found in the product within 15 days upon receipt of the product.
2. Customers are entitled to free repair service from ZHIYUN for any product proven defective in material or workmanship that results in product failure during normal consumer usage and conditions within the valid warranty period, which is 12 months counting from the date of selling. However, warranty period varies by product component and country of purchase. Please contact our after-sales service team on ZHIYUN official website or your place of purchase for detailed warranty information.

### **Warranty Exclusions**

1. Products subjected to unauthorized repair, misuse, collision, neglect, mishandling, soaking, accident, and unauthorized alteration.
2. Products subjected to improper use or whose labels or security tags have been torn off or altered.
3. Products whose warranty has expired.
4. Products damaged due to force majeure, such as fire, flood, lightning, etc.

### **Warranty Claim Procedure**

1. If failure or any problem occurs to your product after purchase, please contact a local agent for assistance, or you can always contact ZHIYUN's customer service through email at [info@zhiyun-tech.com](mailto:info@zhiyun-tech.com) or website at [www.zhiyun-tech.com](http://www.zhiyun-tech.com).
2. Your local agent or ZHIYUN's customer service will guide you through the whole service procedure regarding any product issue or problem you have encountered. ZHIYUN reserves the right to reexamine damaged or returned products.

### Customer Information

Customer Name:

Phone Number:

Address:

### Sales Information

Sales date:

Product Serial Number:

Distributor Name:

Distributor's Contact Number:

### First Maintenance Record

Service Date:

Repairman Signature:

Cause of Problem:

Service Result:

☐ Solved

☐ Unsolved

☐ Refunded/Replaced



Website



Weibo



Vimeo



Google+



Facebook  
(Zhiyun Support)



Facebook  
(Zhiyun Tech)



Youku



Youtube



Wechat



Instagram

Tel: +86 400 900 6868

USA Hotline: +1 808-319-6137, 9:00-18:00 GMT-7, Mon-Fri

Europe Hotline: +49 (0) 61018132180, 10:00-17:00 GMT+1, Mon-Fri

Web: [www.zhiyun-tech.com](http://www.zhiyun-tech.com)

E-mail: [info@zhiyun-tech.com](mailto:info@zhiyun-tech.com)

Address: 09 Huangtong Road, Tieshan Industrial Zone, Qixing District, Guilin, 541004, Guangxi, China

## Certificate of Quality

This product is confirmed to meet quality standards and permitted for sale after strict inspection.

QC Inspector: \_\_\_\_\_



For full product information, please visit ZHIYUN's official website: Content on [www.zhiyun-tech.com](http://www.zhiyun-tech.com) is subject to update without notice.

ZHIYUN™ is a trademark of ZHISHEN

All product names or brands referred to hereunder may be trademarks or registered trademarks of their respective holders.

Copyright © 2023 ZHISHEN. All rights reserved.



ZHIYUN-TECH.COM