

The following features are available in this PDF document.



### **Quick Keyword Search**

Enter the keyword in the search box and hit the search button



### **Quick Jump between Chapters**

Click the title of a specific chapter on the Contents to jump to it

\*Reading software such as Adobe Reader is needed to support the functions above.



# **ZHIYUN CINEPEER CRANE 4E** **Professional Camera Stabilizer**

User Guide

# Contents

□ Product List	
Product List	1
□ Get to Know CRANE 4E	
Get to Know CRANE 4E	3
□ Battery and Charging	
Battery and Charging	5
□ Mounting and Balancing	
Mounting the Tripod	6
Mounting the Camera	6
Balancing	12
□ How to Use ZHIYUN CINEPEER CRANE 4E	
Button Description	14
Touchscreen Introduction	16
Touchscreen Menu	17
Motor Torque Adjustment	19
Bluetooth Shutter Control	21
Gimbal Modes Description	22
Manual Reposition	26
Use with TransMount Video Transmission Transmitter (AI)	27
(hereinafter referred to as "transmitter AI")	27
□ How to Use the App	
Downloading the App	31
How to Connect	31
ZY Play Feature Description	32

❑ Firmware Upgrade & Calibration	
Circumstances When Calibration Is Needed	33
Six-side Calibration	33
Motor Fine-tuning	35
Firmware Upgrade	35
❑ Product Specifications	
❑ Disclaimer and Warning	
Reading Tips	39
WARNING	39
Safe Operation Guidelines	40
❑ Warranty Card	
Warranty Period	41
Warranty Exclusions	41
Warranty Claim Procedure	41
❑ Contact Card	

## Product List

Before using this product, please check carefully that all the following items are included in the product package. In case that any item is found missing, please contact ZHIYUN or your local selling agent.



Gimbal x1



Quick Release Plate x1



Tripod x1

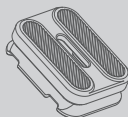

Camera Backing Base x1

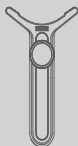

Lens Support x1  
Lens Support Lock Screw x1

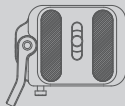

Upper-layer Quick Release Plate x1

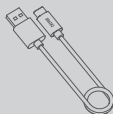

USB Type-C Cable x1

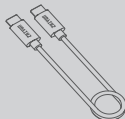

Type-C to Type-C USB LN-UCUC-A02  
Camera Control Cable x1

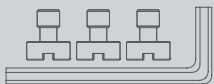

1/4" Screw x3  
M4 Wrench x1\*



Quick Start Guide x1

## Get to Know CRANE 4E

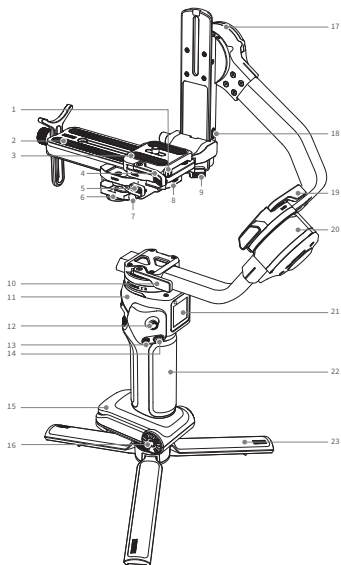

- |  |  |
|--|--|
| 1. Upper-layer Quick Release Plate Safety Lock | 12. Joystick                               |
| 2. Lower-layer Quick Release Plate             | 13. Photo/Video Button                     |
| 3. Upper-layer Quick Release Plate             | 14. Mode Switch                            |
| 4. Upper-layer Quick Release Plate Latch       | 15. Gimbal Base                            |
| 5. Quick Release Plate Latch                   | 16. Sling Grip Installation Screw Hole     |
| 6. Level Mount                                 | 17. Tilt Axis Motor                        |
| 7. Quick Release Plate Safety Lock             | 18. Camera/Image Transmission Control Port |
| 8. Quick Release Plate Leveling Base           | 19. Roll Axis Latch                        |
| 9. Quick Release Plate Leveling Base Latch     | 20. Roll Axis Motor                        |
| 10. Pan Axis Latch                             | 21. Touchscreen                            |
| 11. Pan Axis Motor                             | 22. Gimbal Handle                          |
|  | 23. Tripod                                 |

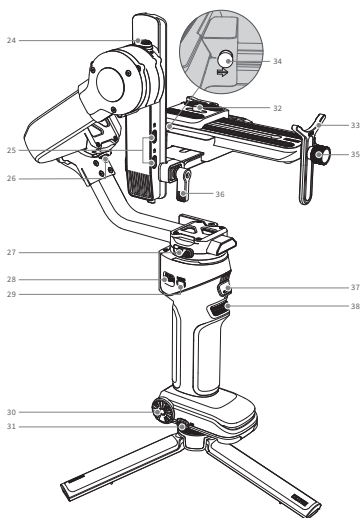

- 24. Tilt Axis Lock Switch
- 25. Focus Motor Control Port
- 26. Roll Axis Lock Switch
- 27. Pan Axis Lock Switch
- 28. Control Wheel
- 29. Power Button
- 30. Wrist Rest Screw Hole
- 31. USB-C Charging Port

- 32. 1/4" Camera Mount Screw
- 33. Lens Support
- 34. Quick Release Plate Leveling Base Latch
- 35. Lens Support Lock Screw
- 36. Level Mount Lock Screw
- 37. Trigger Button
- 38. Adjustment Wheel



### Battery and Charging

CRANE 4E adopts built-in battery. When using CRANE 4E for the first time, please activate the gimbal by fully charging the battery to ensure the proper function of the gimbal.

**Charging method:** Use provided USB Type-C cable to connect the USB charger (not included in the package) to charge CRANE 4E. It is recommended to use USB chargers that meet the PD protocol. (supports 25W PD charging at most).

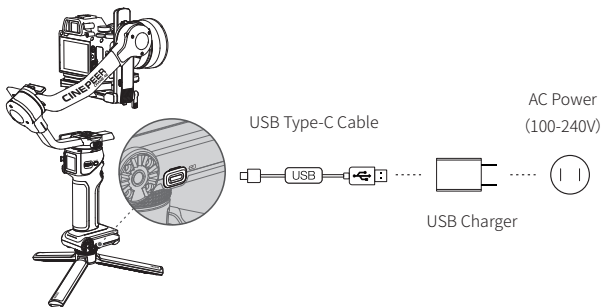

- ① USB charger is not provided.
- ② Please power off CRANE 4E to charge.

### Mounting the Tripod

Mount the tripod to the bottom of the CRANE 4E handle, then unfold the tripod and place the CRANE 4E on a flat surface.

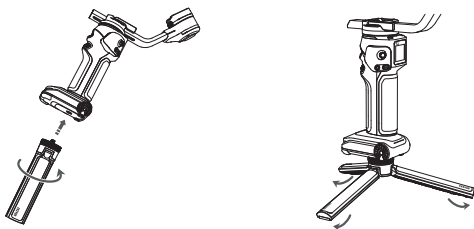

### Mounting the Camera

1. Each axis of the gimbal is equipped with a lock switch. You can use these lock switches to lock the axes for convenient installation and storage. The storage state is the default state. Please toggle the lock switch to unlock the three axes, expand the gimbal as shown in the image, and lock the axes again for convenient camera installation.

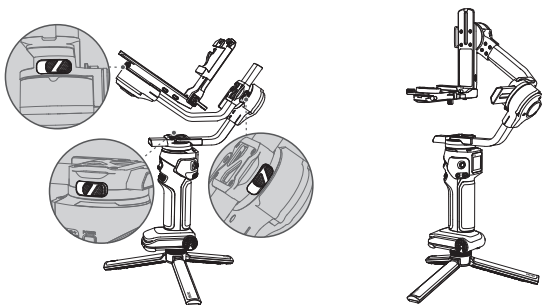

- ① Please mount the camera before powering on CRANE 4E and balance the gimbal. Do not power on CRANE 4E when there's no camera mounted on it.
- ② Before mounting the camera, make sure it is prepared ahead of time. Remove the lens cap and make sure the camera's battery and memory card are already in place.

2. Install the camera onto the upper quick-release plate and tighten the screws ①. Install the upper quick-release plate with the camera onto the lower quick-release plate ②, and lock the upper quick-release plate latch ③. Mount the lens support onto the lower quick-release plate, adjust the height of the lens support according to the lens position to ensure that the lens support can hold the camera lens securely ④, and then tighten the screws ⑤.

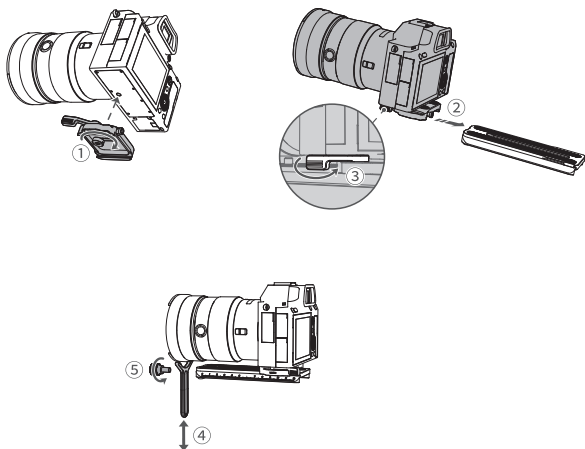

- 💡 When the camera lens is long and heavy, install lens support to ensure stable mounting. Whether to install lens support depends on your needs.
- 💡 If installing the camera with a dual-layer quick-release plate does not allow for balancing, you can use a camera backing base and a lower quick-release plate to install the camera. First, mount the camera onto the camera backing base and tighten the screw ①. Then, install the camera backing base and camera assembly onto the quick-release plate ② and tighten it with screws ③. Install the camera lens support onto the quick-release plate and adjust the height of the lens support according to the position of the lens so that the support can just hold the camera lens, ensuring that the lens is securely mounted ④. Finally, tighten the screw ⑤.

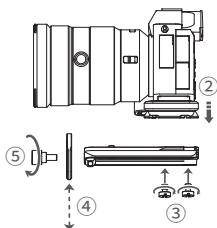
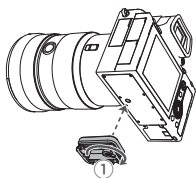

### 3. In the Landscape Orientation

Unlock the quick release plate latch ① , then install the quick-release plate and camera assembly onto the quick release plate leveling base ② . Finally, tighten the latch ③ .

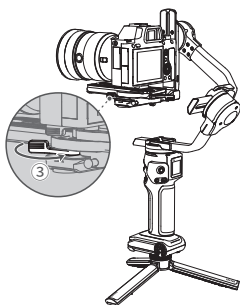
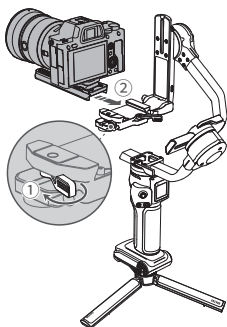

## 4. In the Portrait Orientation

Unlock the quick release plate leveling base latch ① . Hold the leveling base safety lock ② and push it to the left until it is detached from level mount ③ . Install the leveling base onto the tilt axis arm ④ , then lock the leveling base latch ⑤ . Install the camera and dual-layer quick-release plate assembly onto the leveling base ⑥ , and finally, lock the quick release plate latch ⑦ .

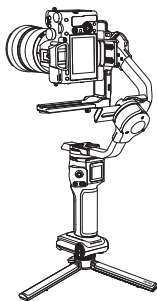
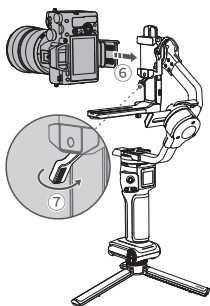
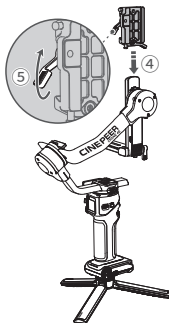
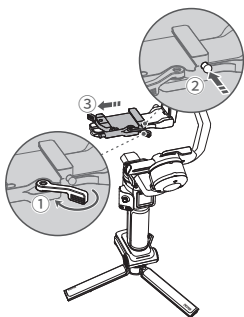

 To remove the camera (in landscape/portrait orientation), first unlock the upper quick-release plate latch ①, then hold down the safety lock of the upper quick-release plate ② and slide the camera and upper quick-release plate assembly out together ③.

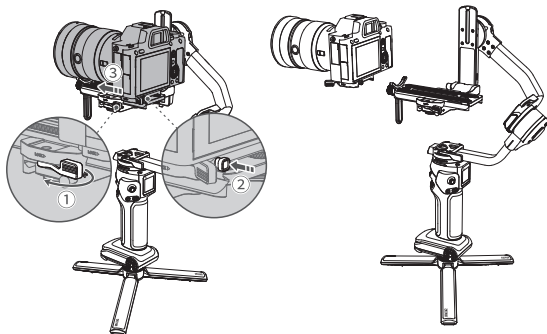

5. Connect the camera control port and camera/image transmission control port of the gimbal with a camera control cable.

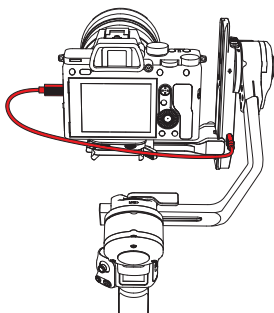

## Balancing

### 1. Horizontal Balance of the Tilt Axis

Unlock the tilt axis lock switch ① and loosen the quick release plate latch ② . Push the camera to move forward or backward ③ until the camera can stay still and almost level with its lens facing front ④ . Complete this step by tightening up the quick release plate latch ⑤ .

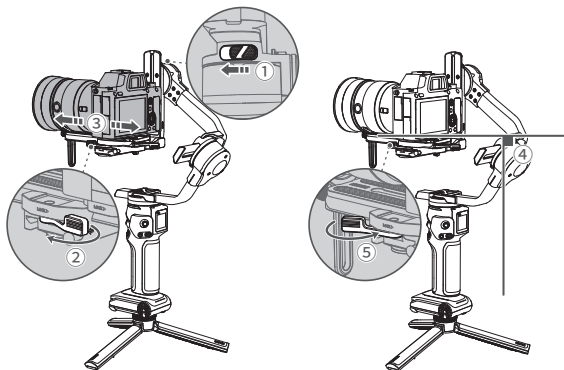

### 2. Vertical Balance of the Tilt Axis

Make the lens face up, loosen the level mount lock screw ① . Push the whole level mount to move forward or backward ② . Push until the camera can stay still with the lens facing up (i.e.the camera stays still and vertical to the ground) ③ . Complete this step by tightening up the screw ④ .

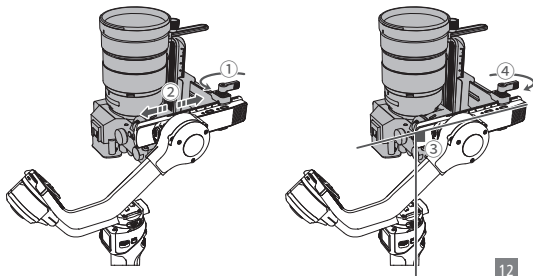



## 3. Roll Axis Balance

Unlock the roll axis ① and loosen the roll axis latch ② . Push the roll axis to move left or right ③ until the camera can stay still and horizontal to the ground ④ . Complete this step by tightening up the latch ⑤ .

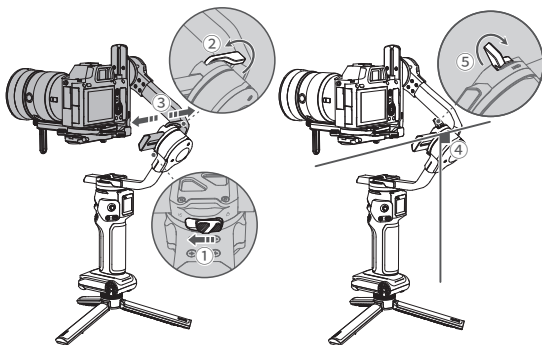

## 4. Pan Axis Balance

Unlock the pan axis ① , loosen the pan axis latch ② , hold and slightly tilt the handle, push the pan axis to move left or right ③ until the pan axis can stay still in any position. Complete this step by tightening up the pan axis latch ④ .

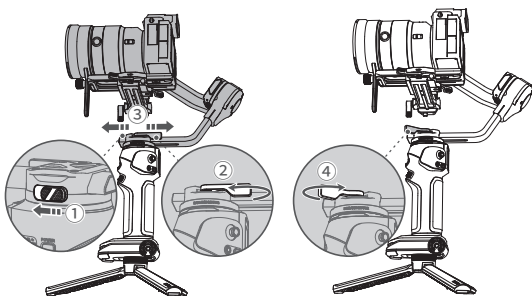

💡 ① The balancing steps for the portrait orientation are the same as the landscape orientation.

② After balancing CRANE 4E the motor torque needs to be adjusted for proper function. For the adjustment details, please see the methods introduced in "Motor Torque Adjustment".

## Button Description

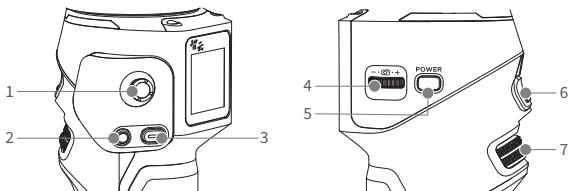

### 1. Joystick

Push up/down/left/right to control the gimbal to rotate.



### 2. Photo/Video Button

Half press: Activate auto-focus on certain cameras.

Long press: Take a photo.

Single press: Start/stop filming a video.



### 3. Mode Switch

Single press: Switch among PF/L/F mode.

Double press: Switch among POV/V/Portrait mode.

Long press: Sleep/wake mode for the gimbal motors.



### 4. Control Wheel

Single press: Cycle through aperture/shutter/  
iso adjustment interface

Scroll: Adjust the aperture/shutter/iso of the camera



### 5. Power Button

Single press: Lock/unlock the touch screen

Long press: Turn on/off the gimbal.



### 6. Trigger Button

Single press: Switch to customized gimbal mode  
(Follow mode by default)/Return to the previous mode.

Trigger the C1 button mapping function on some Sony cameras.

Double press: Gimbal reposition.

Triple press: Selfie mode.

Long press:

Enter Go mode. Release to return to the previous mode.

When in the portrait orientation, long press to lock the gimbal. Motors of three axes won't move with the handle. Release to unlock the gimbal and the motors of the tilt axis and roll axis will move with the handle.



### 7. Adjustment Wheel

Scroll: Adjust parameters customized in the screen menu (aperture, shutter, ISO, digital focus/zoom, roll axis, tilt axis, pan axis).

## Touchscreen Introduction

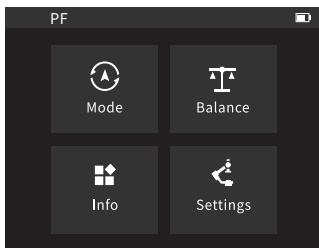

Main page (set as default)

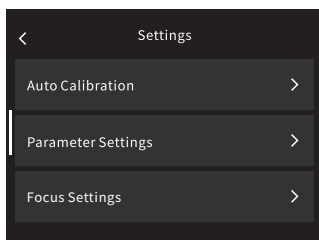

Gimbal Settings Interface

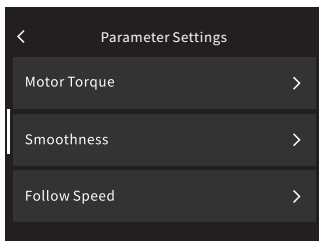

Parameter Settings Interface

💡 Swipe right at the left edge of the screen to return to the previous menu.

## Touchscreen Menu

**Mode:**

For selecting gimbal modes. Available modes are: Pan Follow Mode (PF)/Lock Mode (L)/POV Mode (POV)/ Follow Mode (F)/Go Mode (GO)/Vortex Mode (V)/Portrait Mode.

**Balance:**

Can check and view the balance status of three gimbal axes in real-time.

**Info:**

1. Language: Switch the language of the touchscreen menu (simplified Chinese/English)
2. Device Info: See the device information such as device name/device model/SN/firmware version
3. Factory Reset: Tap to factory reset the gimbal.



### Settings:

1. Auto Calibration: To perform auto-calibration after the balancing is finished.
2. Parameter Settings: Sets the motor torque/smoothness/follow speed/joystick speed/deadband of the gimbal.
3. Follow Focus Wheel: Set the sensitivity/AB point/direction of the follow focus wheel.
4. Control Wheel: Customize the adjustment wheel. Can be customized to control aperture/shutter/ISO/zoom/focus/roll axis/tilt axis/pan axis
5. Control Wheel Setting: Sets the orientation/sensitivity of adjustment wheel parameter adjustment.
6. Parameter Reset: Reset the parameters to default.
7. Trigger Button: Customize the gimbal mode when pressing the trigger button once.

How to use the C1 button mapping function:

- ① Set the trigger function in the gimbal's settings menu to "Sony C1 Mapping."
  - ② Set the C1 button on the camera to the desired function.
- 💡 The C1 button mapping function is only supported when the Bluetooth shutter is connected.
8. Bluetooth Shutter Control: Connect the camera Bluetooth to wirelessly control the camera.
  9. Motor Fine-tuning: Fine-tune the roll axis/tilt axis angle of the gimbal.
  10. Shooting: Set the shooting features in the gimbal (Panorama/Timelapse/Motionlapse/V Mode).

## Motor Torque Adjustment

After balancing CRANE 4E, the motor torque needs to be adjusted for proper function. You can adjust the motor torque according to the weight of your camera and lens, so that the CRANE 4E can be used in its ideal state. Following are three methods for adjustment. It is recommended to use auto-calibration.

### 1. Auto calibration:

Auto calibration will adjust the motor torque according to the weight of the carried camera and lens.

#### Operation steps:

Select "Settings" - "Auto Calibration", tap to enter calibration. You can see the calibration progress on the screen.

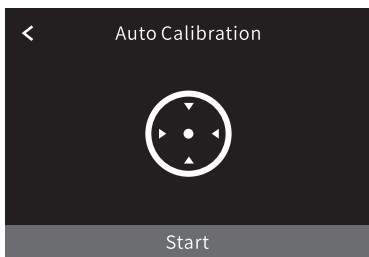

💡 When performing auto-calibration, please make sure that the gimbal is balanced, the three axes are unlocked and the gimbal is straightly put on a flat surface. Please don't touch the gimbal when calibrating.

## 2. Motor Torque:

Three levels (Low/Medium/High) are provided based on the mainstream lens combo weight in the market. Select the appropriate level according to the weight of the carried camera and lens.

### Operation steps:

Select "Settings" - "Parameter Settings" - "Motor Torque" to enter motor torque setting interface.

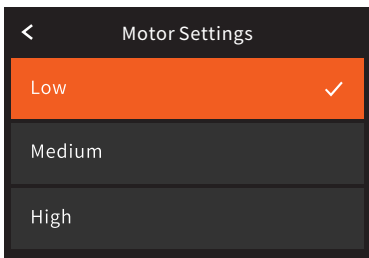

## 3. Customization

Motor torque determines the motor torque strength and needs to be adjusted based on the weight of the carried camera and lens. The torque strength is proportional to the load weight. Excessive torque strength can cause gimbal shaking, while insufficient strength can affect stabilization performance.

### Operation Steps

Select "Settings" - "Parameter Settings" - "Motor Torque" - "Customization" to enter custom motor torque setting interface. Set the motor torque for the three axes, and the parameters will be saved instantly.

- 💡 ① If the motor torque is too low/high for the payload, the camera will shake and affect the gimbal performance. Please choose proper motor torque.
- ② When setting the motor torque, please make sure that three gimbal axes are unlocked and the gimbal is straightly put on a flat surface.
- ③ Prioritize using "Auto Calibration." If "Auto Calibration" does not meet the requirements, select custom torque settings. If neither of these methods suffices, consider adjusting the motor torque level parameters.
- ④ When the camera lens is changed, please balance the gimbal again and adjust the motor torque with the methods above.



## Bluetooth Shutter Control

CRANE 4E supports Bluetooth shutter control, which allows you to wirelessly control the camera shutter without connecting a camera control cable. Before connecting the camera Bluetooth to CRANE 4E, please turn on the camera's Bluetooth and enter pairing mode. Then tap the "Gimbal Setting" in the touchscreen menu, select "Bluetooth Shutter Control", make sure the camera Bluetooth is turned on and tap to confirm. CRANE 4E will then automatically search for the camera's Bluetooth name. Select the Bluetooth name that needs to be connected, and finally confirm the connection on the camera.

- 💡 ① After CRANE 4E and the camera complete pairing and successfully connect Bluetooth for the first time, they can automatically connect to Bluetooth next time.
- ② When CRANE 4E and the camera are connected through both camera control cables and Bluetooth at the same time, the gimbal prioritizes controlling the camera function through the camera control cable.
- ③ After CRANE 4E and the camera are connected via Bluetooth, the Bluetooth connection can be disconnected in the Bluetooth shutter control menu.
- ④ For specific camera models that support Bluetooth control in CRANE 4E please visit the ZHIYUN official website [www.zhiyun-tech.com](http://www.zhiyun-tech.com) to check the "CRANE 4E Camera Compatibility List" for the latest information.

## Gimbal Modes Description

💡 Motors circled in red are free to move in line with the movement of the gimbal handle while motors circled in grey are locked.

### Pan Follow mode (PF):

The tilt axis and roll axis motors are locked, and the camera rotates with the handle while panning horizontally. Push the joystick up/down to control the tilt axis angle, and push it left/right to control the pan axis of the camera.

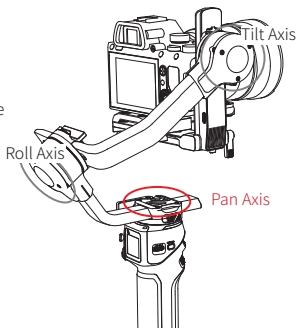

### Lock mode (L):

All three motor angles are locked, and the camera orientation will not move with the rotation of the handle. Push the joystick up/down to change the tilt angle of the camera and left/right to change the horizontal orientation of the camera.

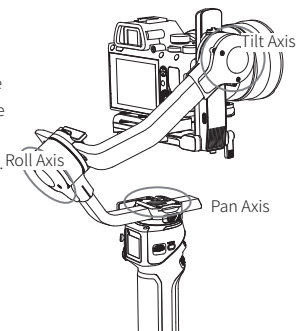

**Follow mode (F):**

The roll axis motor is locked, and the tilt axis and pan axis motors follow the rotation of the handle. Push the joystick up/down to change the tilt angle of the camera and left/right to change the horizontal orientation of the camera.

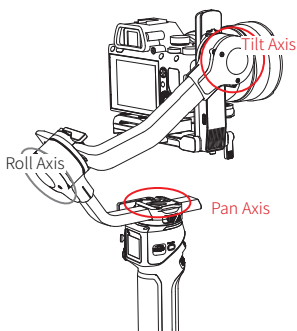
**Point of View mode (POV):**

All three motors move when the handle is rotated. Push the joystick up/down to change the tilt angle of the camera and left/right to change the horizontal orientation of the camera.

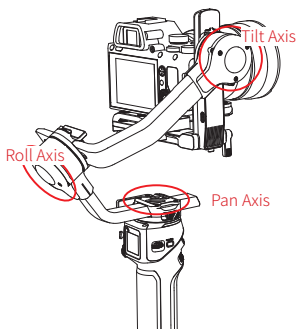

**Vortex mode (V):**

The tilt axis motor rotates upward by 90°, and the tilt axis, roll axis, and pan axis motors follow the rotation of the handle. Push the joystick to the left/right to control the rotation of the pan axis.

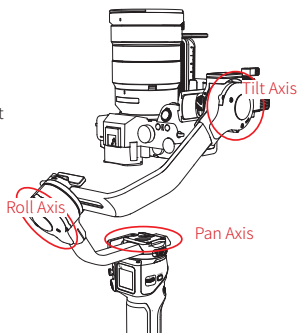
**Go Mode (GO):**

The roll axis motor is locked, and the tilt axis and pan axis motors quickly follow the rotation of the handle. Push the joystick up/down to change the tilt angle of the camera and left/right to change the horizontal orientation of the camera.

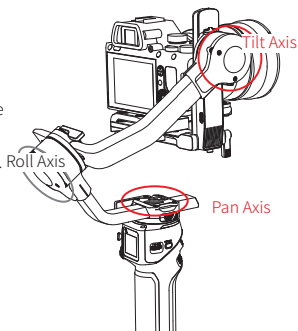

### Portrait mode

The tilt axis motor rotates upward by  $90^{\circ}$  and the pan axis rotates counterclockwise by  $90^{\circ}$ . You can enter this mode for vertical filming.

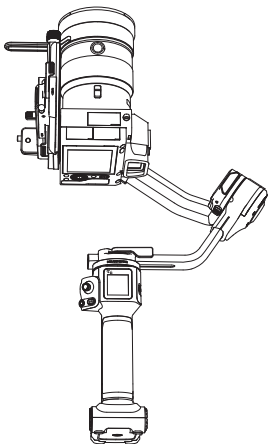

### Manual Reposition

In Pan Follow mode(PF), Lock mode(L), and Follow mode(F), the camera can be rotated by a certain angle by hand. Hold it for 2s and the camera angle will be fixed at that angle after you release the camera.

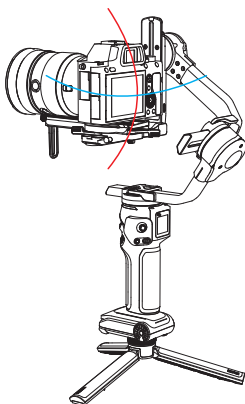

## Use with TransMount Video Transmission Transmitter (AI) (hereinafter referred to as "transmitter AI")

### Installing

1. Take out the transmitter mounting plate, mount the transmitter mounting plate to the bottom of the CRANE 4E's level mount (note the direction of the notch), and use the wrench to tighten the screws.

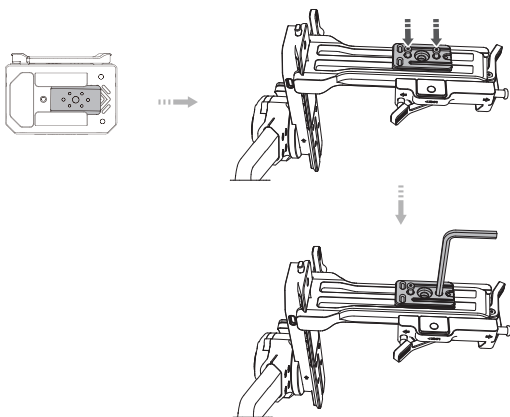

2. Place the transmitter AI with the mounting plate slot facing up, align the transmitter mounting plate, push the transmitter AI toward the tilt axis motor until it clicks into the safety lock to make sure of a firm installation.

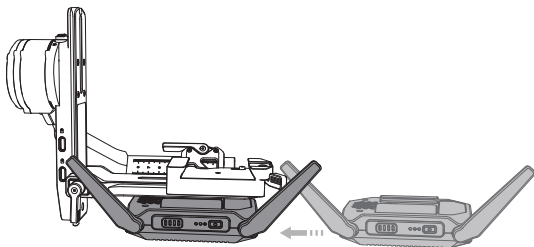

💡 In order to have the best image transmission, please rotate the antenna to the position as shown in the image. The antenna can only be rotated in one direction. Please rotate properly. For more details, please read the user guide for transmitter AI



## Connecting

1. Take the gimbal-only cable (Type-C to Type-C LN-UCUC-A02), connect with the camera/image transmission control port of CRANE 4E and the Type-C charging/communication port of the transmitter AI.

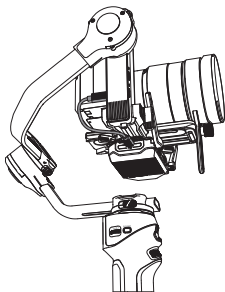



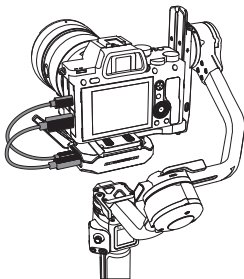

2. Take the camera control cable corresponding to the USB port model of the camera, connect to the camera control port of the transmitter AI and the USB port of the camera. Use the HDMI cable corresponding to the HDMI port model of the camera, connect to the HDMI video input port of the transmitter AI and the HDMI output port of the camera.



- 💡 ① CRANE 4E can also be used with TransMount Image Transmission Transmitter 2.0. The installation steps are similar to those for transmitter AI. Please choose proper cables when installing.
- ② It is recommended that the CRANE 4E and transmitter AI be shut down and powered off before plugging in or out the cable.
- ③ To know how you can connect the camera control cable and the HDMI cable, please visit the official website of ZHIYUN ([www.zhiyun-tech.com](http://www.zhiyun-tech.com)) to find "TransMount Video Transmission Transmitter AI Camera Compatibility List".
- ④ After installing the device, you need to adjust the balance of the CRANE 4E.

### Using

1. Power on CRANE 4E, transmitter AI and camera. When the screen on CRANE 4E shows the icon[  ]and gives a“ beep” sound, the connection is successful. You can then control the camera via the gimbal buttons.
2. Launch the “ZY Play” app. Select the CRANE 4E page and tap to connect. Select the Bluetooth name of your CRANE 4E to connect. (the CRANE 4E Bluetooth name can be found on the tilt axis USER ID: XXXX).
3. When the app enters the image transmission interface, tap the Wi-Fi icon[  ], and follow the instructions to connect the transmitter AI Wi-Fi (default password: 12345678). Tap the image transmission icon[  ], to enable image transmission. You can then watch the real-time footage of the camera on “ZY Play” app. You can also use the virtual joystick on the app to control the camera to take photos/shoot videos or control the gimbal to rotate.

 The transmitter AI should be used with the“ZY Play” app. To know how you can download the app, please see the method introduced in“How to Use the App”

### Downloading the App



Scan the QR code on the left (Android 5.0 and above, iOS 9.0 and above required) or search "ZY Play" in App Store or Google Play to download.

- 💡 ① "ZY Play" is an app dedicatedly designed for CRANE 4E. When activated CRANE 4E via "ZY Play", you can also use it for firmware upgrades, virtual joystick control, six-side calibration, etc.
- ② ZY Play is subject to updates without notice. Please always refer to the latest version.

### How to Connect

1. Power on CRANE 4E and turn on Bluetooth on the smartphone.
2. Launch the "ZY Play" app. Select the CRANE 4E page and tap to connect. Select the Bluetooth name of your CRANE 4E to connect (the CRANE 4E Bluetooth name can be found on the side of the tilt axis USER ID: XXXX).
3. If the CRANE 4E is being used for the first time, you need to activate the gimbal via "ZY Play" to use the advanced features in the app. Internet connection is required.
4. After the activation succeeds, you can enter the feature interface of ZY Play App.

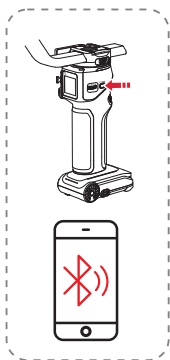

1



2

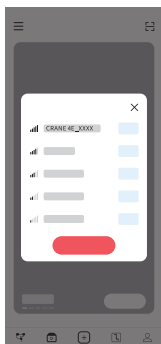

3

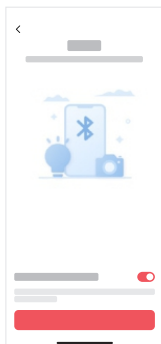

4

### ZY Play Feature Description



💡 For more details of the “ZY Play” app features, please visit the official website of ZHIYUN ([www.zhiyun-tech.com](http://www.zhiyun-tech.com)) and watch CRANE 4E video tutorials.

## Circumstances When Calibration Is Needed

Calibrate the gimbal as needed.

Calibration Reason	Calibration Method
1. Slight deviation is found in the level position after the initialization of the gimbal. 2. The gimbal has not been used for a long time. 3. The gimbal undergoes significant temperature differences in operation environments.	Six-side Calibration
Slight deviation is found in the tilt or roll angle in level position after six-side calibration of the gimbal.	Motor Fine-tuning

## Six-side Calibration

### 1. Six-side calibration via APP:

According to the method introduced in "How to Use the App", please connect the gimbal to the APP, and enter "Settings" - "Six-side Calibration", then conduct the six-side calibration according to the prompt.

### 2. Six-side calibration via "Zhiyun Gimbal Tools":

Power on the gimbal and enter standby mode. Connect the charging/upgrade port of the gimbal to the computer with the Type-C USB cable, Open "Zhiyun Gimbal Tools", click "open" on the top and click "calibration" on the bottom. Please conduct the process according to the following steps. A "√" mark will appear after the calibration is completed.

- 💡 ① Please refer to the six-side calibration steps below. After the calibration is completed, please restart the gimbal.
- ② In simple terms, six-side calibration is to place all six sides of the tilt axis arm vertically to a level surface respectively.

Step 1

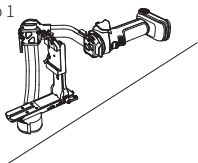

Step 2

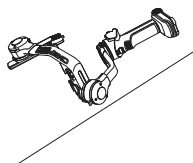

Step 3

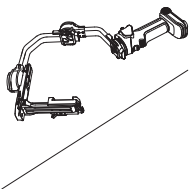

Step 4

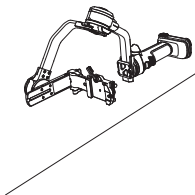

Step 5

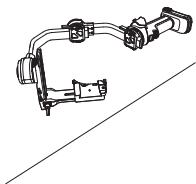

Step 6

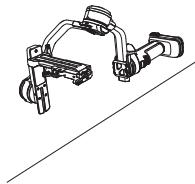

## Motor Fine-tuning

Select the "Settings" in the touchscreen menu and select "Motor fine-tuning" to enter the tilt axis/roll axis angle fine-tuning interface.

## Firmware Upgrade

You can use "Zhiyun Gimbal Tools" or "ZY Play" App to upgrade the firmware of CRANE 4E.

Method One:

1. Visit the official website of ZHIYUN ([www.zhiyun-tech.com](http://www.zhiyun-tech.com)), go to the CRANE 4E product page, click "Download", find the USB driver, the calibration upgrade tool and the firmware and download. (USB drivers are not required for Mac OS systems).
2. Install the driver, unzip the firmware for the documents with the ".ptz" file extension.
3. Connect the Type-C charging/upgrade port of CRANE 4E to the computer with the Type-C USB cable, power on CRANE 4E.
4. Open "Zhiyun Gimbal Tools", click "Open", click "Firmware Upgrade". Click "Browse" under "Path" to select the latest firmware downloaded (with the ".ptz" file extension), and click "Upgrade" at the bottom to upgrade firmware.

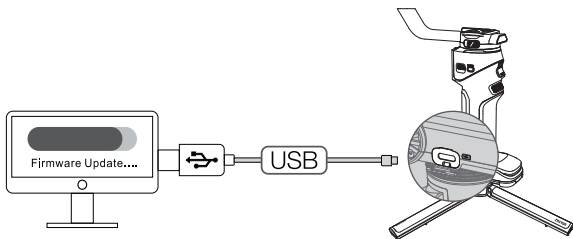

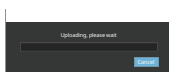
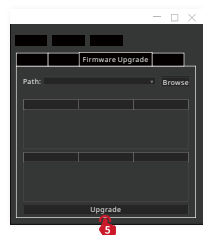
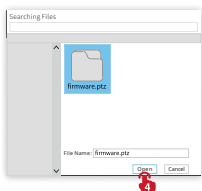
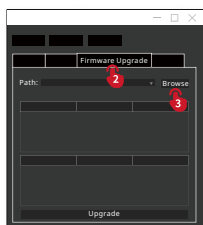
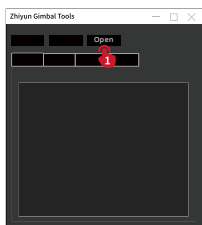

## Method Two:

When CRANE 4E is connected to “ZY Play” app, if a firmware upgrade prompt pops up on the app, please follow the instructions to upgrade. Internet connection is required. To know how you can connect CRANE 4E to “ZY Play”, please check the method introduced in "How to Use the App".

- 💡 ① When upgrading via Method One, please wait until the screen displays that the upgrade is finished, then you can plug out the USB Type-C cable.
- ② Before upgrading the firmware, please ensure that the CRANE 4E has more than 50% power remaining. You will not be able to exit the app interface or access in the background during the upgrading process. Pay attention to the prompts on the app.



Product Model: CR131

Item	Min.	Standard	Max.	Remark
Operation Voltage	11V	14.8V	16.8V	
Operation Current	200mA	-	14500mA	
Output Voltage (Camera Control Port)	-	5V	-	
Output Current (Camera Control Port)	-	1A	-	
Tilt Mechanical Range	-103°	-	+220°	
Roll Mechanical Range	-251°	-	+71°	
Pan Mechanical Range	-	360°	-	
Controllable Tilt Angle	-100°	-	+215°	
Controllable Roll Angle	-35°	-	+35°	
Controllable Pan Angle	-	360°	-	Unlimited Rotation
Operation Temperature	-10°C	25°C	45°C	
Battery Capacity	-	2600mAh	-	
Battery Runtime		12H		Lab Data 1
Charging Time		2H		Lab Data 2
Gimbal Net Weight		1.63kg		Without tripod
Gimbal Size (Folded)		340*280*70mm		W*D*H
Bluetooth		Bluetooth 5.0		
EIRP		< 10dBm		

Operation Frequency	2.4GHz
Camera Charging	Able to charge 5V / 1A cameras
1/4" Rosette Mount Screw Thread Carry Weight	Carry weight < 6kg
Touchscreen Size	1.22inch

Lab Data 1: This data was obtained under the condition of a fully charged CRANE 4E, mounted with Canon 5Ds R+ EF24-105mm f/4L. The gimbal is balanced and placed in the static status, and the battery only supplies power to the gimbal, at an ambient temperature of 25°C . The maximum runtime was 12 hours. When the battery supplies power to the gimbal and charges the camera simultaneously, the battery life will be shortened. Please determine whether to enable the camera USB power supply function as required. The actual usage time will vary depending on the duration of CRANE 4E use, the number of battery charge and discharge cycles, and the battery activity. The longer the CRANE 4E has been used, the more battery charge and discharge cycles, and the lower the battery activity, the shorter the continuous usage time.

Lab Data 2: This data was obtained under the condition of using 25W PD fast charging at an ambient temperature of 25°C , and the charging time was 2 hour. The charging time may vary due to environmental factors, and actual results may differ. In addition, the lower the charging environment temperature, the smaller the charging current, and the longer the charging time.

Any data mentioned in this user guide is the result of internal testing at ZHIYUN Lab. Under different objective conditions, there may be varying degrees of error in the data. Please refer to actual experience with the device.

Thank you for purchasing this product. The information contains herein affects your safety, legitimate rights and obligations. Please read this instruction carefully to ensure proper configuration before use. Failure to read and follow this instruction and warnings herein may result in serious injury to you or bystanders, or damage to your device or property. Guilin Zhishen Information Technology Co., Ltd (hereinafter referred to as "ZHIYUN") reserves all rights for final explanation on this instruction and other documents related to the product. The information is subject to update without notice. Please visit [www.zhiyun-tech.com](http://www.zhiyun-tech.com) to obtain the latest product information.

By using this product, you hereby signify that you have read this document carefully and that you understand and agree to abide by the terms and conditions herein. You agree that you are solely responsible for your own conduct while using this product, and for any consequences thereof. You agree to use this product only for purposes that are proper and in accordance with all terms, precautions, practices, policies and guidelines ZHIYUN has made and may make available.

ZHIYUN accepts no liability for damage, injury or any legal responsibility incurred directly or indirectly from the use of this product. Users shall observe safe and lawful practices including, but not limited to, those set forth herein.

ZHIYUN™, TransMount™ are the trademarks of Guilin Zhishen Information Technology Co., Ltd and its affiliates. All product names or trademarks referred to herein are trademarks or registered trademarks of their respective holders.

### Reading Tips

Legends:  Hints and Tips

 Important

### WARNING

Read the ENTIRE User Guide to become familiar with the features of this product before operating. Failure to operate the product correctly can result in damage to the product or personal property and cause serious injury. This is a sophisticated product. It must be operated with caution and common sense and requires some basic mechanical ability. Failure to operate this product in a safe and responsible manner could result in injury or damage to the product or other property. This product is not intended for use by children without direct adult supervision. DO NOT use with incompatible components or in any way otherwise as mentioned or instructed in the product documents provided by ZHIYUN. The safety guidelines herein contain instructions for safety, operation and maintenance. It is essential to read and follow all of the instructions and warnings in the User Guide, prior to assembly, setup or use, in order to operate the product correctly and avoid damage or serious injury.

### **Safe Operation Guidelines**

1. This product is a high-precision control device. Damage may be caused to this product if dropped or subjected to external force, and this may result in malfunction.
2. Make sure the rotation of the gimbal axes is not blocked by external force when this product is turned on.
3. This product is not waterproof. Prevent contact with any kind of liquid or cleaner with this product. It is recommended to use dry cloth for cleaning.
4. Protect this product from dust and sand during use.

### **Warranty Period**

1. Customers are entitled to replacement or free repair service in case of quality deficits found in the product within 15 days upon receipt of the product.
2. Customers are entitled to free repair service from ZHIYUN for any product proven defective in material or workmanship that results in product failure during normal consumer usage and conditions within the valid warranty period, which is 12 months counting from the date of selling. However, warranty period varies by product component and country of purchase. Please contact our after-sales service team on ZHIYUN official website or your place of purchase for detailed warranty information.

### **Warranty Exclusions**

1. Products subjected to unauthorized repair, misuse, collision, neglect, mishandling, soaking, accident, and unauthorized alteration.
2. Products subjected to improper use or whose labels or security tags have been torn off or altered.
3. Products whose warranty has expired.
4. Products damaged due to force majeure, such as fire, flood, lightning, etc.

### **Warranty Claim Procedure**

1. If failure or any problem occurs to your product after purchase, please contact a local agent for assistance, or you can always contact ZHIYUN's customer service through email at [info@zhiyun-tech.com](mailto:info@zhiyun-tech.com) or website at [www.zhiyun-tech.com](http://www.zhiyun-tech.com).
2. Your local agent or ZHIYUN's customer service will guide you through the whole service procedure regarding any product issue or problem you have encountered. ZHIYUN reserves the right to reexamine damaged or returned products.

**Customer Information**

Customer Name:

Phone Number:

Address:

**Sales Information**

Sales date:

Product Serial Number:

Distributor Name:

Distributor's Contact Number:

**First Maintenance Record**

Service Date:

Repairman Signature:

Cause of Problem:

Service Result:

☐ Solved☐ Unsolved☐ Refunded/Replaced



Website



Weibo



Vimeo



Google+



Facebook  
(Zhiyun Support)



Facebook  
(Zhiyun Tech)



Youku



Youtube



WeChat



Instagram

Tel: +86 400 900 6868

USA Hotline: +1 808-319-6137, 9:00-18:00 GMT-7, Mon-Fri

Europe Hotline: +49 (0) 61018132180, 10:00-17:00 GMT+1, Mon-Fri

Web: [www.zhiyun-tech.com](http://www.zhiyun-tech.com)

E-mail: [info@zhiyun-tech.com](mailto:info@zhiyun-tech.com)

Address: 09 Huangtong Road, Tieshan Industrial Zone, Qixing District, Guilin, 541004, Guangxi, China

## Certificate of Quality

This product is confirmed to meet quality standards and permitted for sale after strict inspection.

QC Inspector: \_\_\_\_\_



For full product information, please visit ZHIYUN's official website: Content on [www.zhiyun-tech.com](http://www.zhiyun-tech.com) is subject to update without notice.

ZHIYUN™ is a trademark of ZHISHEN

All product names or brands referred to hereunder may be trademarks or registered trademarks of their respective holders.

Copyright © 2024 ZHISHEN. All rights reserved.



ZHIYUN-TECH.COM